

Models ZKW1, ZKW11, ZKW1L, ZKW11L

UNITROL PRESSURE CONTROL SET

with Chemical Injector*

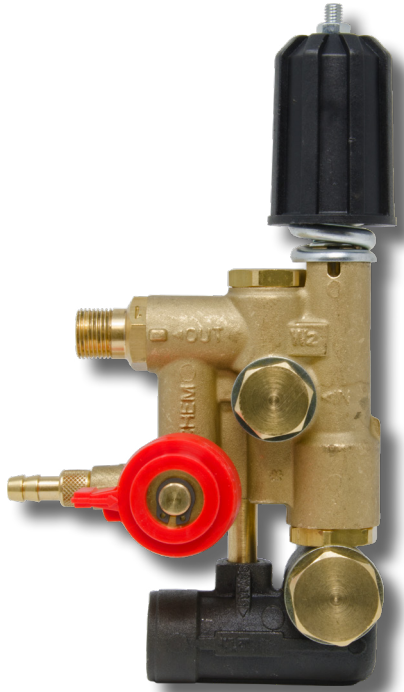

General Pump recommends using a safety relief device in conjunction with this unloader valve when installed on a positive displacement pump. General Pump is not liable and assumes no responsibility for this valve when used in a customer's high pressure system.

FEATURES

- Reduces Cost - Eliminates the need for fittings and bypass hose.
- Compact Design - Features forged brass body and hardware.
- Versatile - Mounts in seconds to either side of pump manifold.
- Adjustable Unloader Valve - Trapped pressure type with internal bypass system.
- Built-In Chemical Injector - Includes variable metering adjustment.

SPECIFICATIONS

Flow Range:	ZKW1, ZKW1L	2.0 - 3.0 GPM
	ZKW11, ZKW11L	3.0 - 4.0 GPM
Max Pressure:		1,600 PSI
Max Temp:		165° F
Inlet Port:	ZKW1, ZKW11	3/8-19 BSP-F
	ZKW1L, ZKW11L	1/2-14 BSP-F
Outlet Port:		3/8-19 BSP-M
Chemical Inlet:		1/4" I.D. Hose
Weight:		2.5 lbs
Dimensions:		7.25" x 2.75" x 5.25"

Model ZKW1, ZKW1L	2.0 - 3.0 GPM
Model ZKW1	TT551, TT561, TT9061, TT751, TT901
Used on pump models:	TT931, T9051, TT9061, TT9071, TS1021
Model ZKW1L	T521, T531, T701, T731, T981
Used on pump models:	T9721, T9731, T9791
Model ZKW11, ZKW11L	3.0 - 4.0 GPM
Model ZKW11	TT661, TT941
Used on pump models:	
Model ZKW11L	T711, T911, T991, T9951, T9961
Used on pump models:	

- *Notes: 1. All Unitrol models may be ordered without chemical injector by adding suffix letters "SC" to order.
 2. Optional suction nipple/o-ring available - see parts list.



ZKW1 SERIES

Control Set

GENERAL PUMP A member of the Interpump Group

PARTS LIST

ZKW1 Pressure Control Set

No.	Part No.	Description	Qty.
1	90383900	O-ring, 15.8x2.62 (W1, W11)	1
	93197200	Washer, (W1L, W11L)	1
2	98205700	Cap, M14x1.5	1
3	10007870	Nipple	1
4*	90383200	O-ring, 13.95x2.62, (W1, W11)	1
5	90383300	O-ring, (W1L, W11L)	1
	93185800	Washer	1
6†	36316766	Valve	1
7†	90502500	Anti-ex., Ring	1
8†	90357500	O-ring	1
9†	90507500	Ant-ex., Ring	1
10†	90358900	O-ring	1
11†	36316570	Valve Guide	1
12†	90384700	O-ring	1
13†	36316670	Bushing Guide	1
14	94743600	Spring	1
15	36316970	Spring Plate	1
16	36317102	Knob	1
17	92220000	Nut	1
18	99305200	Screw	1
19	36317251	Cap	1
20†	90506500	Anti-ex., Ring	2
21*†	90382200	O-ring	2
22†	36316866	Control Piston	1
23†	97613200	Pin	1
24†	97480000	Ball	1
25†	36316466	Valve Seat	1
26	36316301	Valve Body, (W1, W11)	1
	36317301	Valve Body, (W1L, W11L)	1
27	90382000	O-ring, (W1, W11L)	1
	90382700	O-ring, (W1L, W11L)	1
28	36256770	Valve Ball, (W1, W11)	1
	36256870	Valve Ball, (W1L, W11L)	1
29	90382500	O-ring	1
30	36315222	Connector, (W1, W11L)	1
	36317422	Connector, (W1L, W11L)	1
31	90382700	O-ring, (W1, W11)	1
	90384100	O-ring, (W1L, W11L)	1
32	36256870	Valve Bolt, (W1, W11)	1
	36317570	Valve Volt, (W1L, W11L)	1
36	90359100	O-ring (optional, sold sep.)	1
37	36258470	Suction Nipple (optional, sold sep.)	1
46	10015166	Nozzle, 2.1-2.9 GPM, (W1, W11)	1
	1007666	Nozzle, 3.1-3.9 GPM, (W1L, W11L)	1
47*	90358200	O-ring	1
48*	94821700	Taper Spring	1
49*	97478200	Ball	1
50*	90357200	O-ring	1
51*	90358500	O-ring	1
52	36256370	Chem. Valve Seat	1
53	36256251	Chem. inetor Body	1
54*	94738300	Spring	1
55*	90385000	O-ring	1
56	36256470	Injector Shutter	1
57	36256551	Chem. Reg. Knob	1
58*	90357000	O-ring	2
59	36256670	Hose Barb Fitting	1
*	Kit94	Repair Kit	
†	Kit98	Repair Kit	

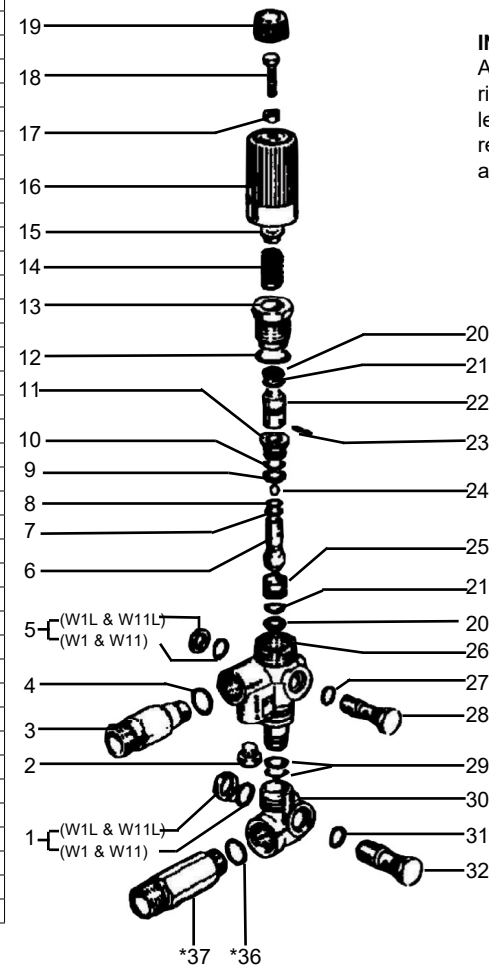
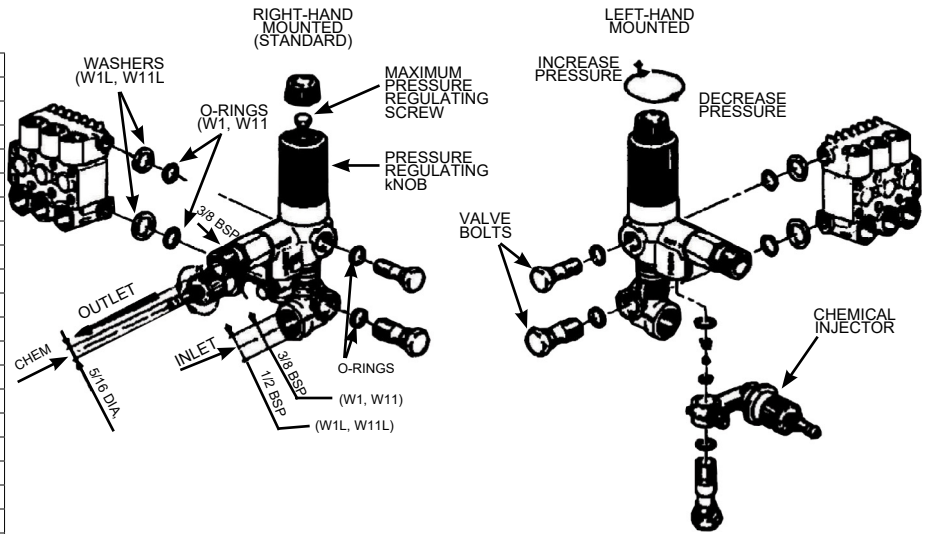

INSTALLATION

All Unitrol units are shipped ready for right-hand mounting to pump. If left-hand mounting is desired, simply reverse chemical injector and valve bolts as shown in illustration.

