



SPECIFICATIONS

Part Number		ZKSR
Volume	Pressure Relief Valve:	1.3 - 10.8 GPM
	Regulating Valve:	1.6 - 5.5 GPM
Maximum Pressure		3,000 PSI
Port Size	Inlet	3/8" BSP-M
	Bypass	1/4" BSP-F
Weight		1.5 lb.
Materials		Brass, Stainless Steel

FEATURES

- The ZKSR is a pressure relief valve which permits regulation of the bypass pressure:
 - As a pressure relief and regulating valve, for flow rate of 1.6 to 5.5 GPM
 - As a pressure relief valve only, for flow rates up to 10.8 GPM
- Brass and Stainless Steel construction

PARTS LIST

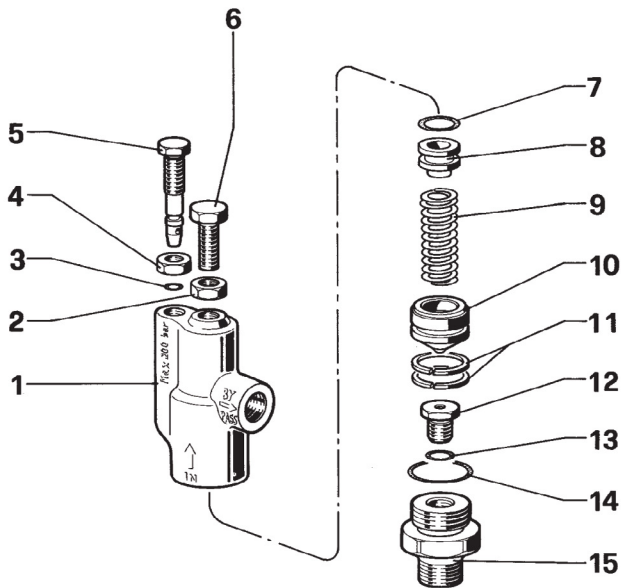

No.	Part No.	Description	Qty.
1	36259641	Valve Body	1
2	92221800	Locking Nut	1
3	90356600	O-ring	1
4	92220000	Locking Nut	1
5	36260070	Bypass Regulation Screw	1
6	99305600	Pressure Regulation Screw	1
7	90382500	o-ring	1
8	36260170	Spring Plate	1
9	94739600	Spring	1
10	36260202	Piston	1
11	92770700	Ring	1
12	36259866	Valve Seat Insert	1
13	90357800	O-ring	1
14	90360000	O-ring	1
15	36259770	Valve Seat	1

INSTRUCTIONS

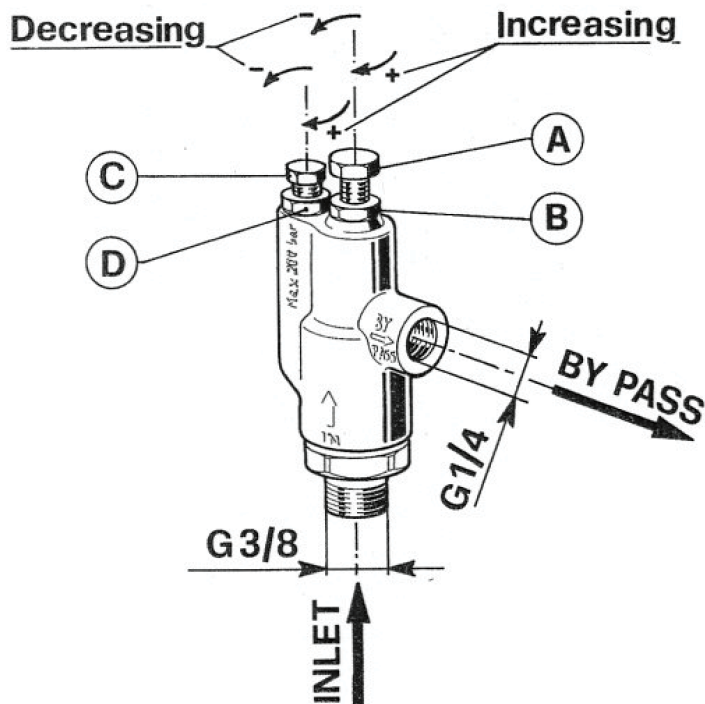

HOW TO ADJUST THE ZKSR

- Start up Settings:** Completely loosen screw "A". Loosen screw "C" approximately 5 turns from the position of maximum tightness.
- Adjustment of Working Pressure:** Start up the pump with the gun open. The water flow will be intermittent. Tighten screw "A" until the flow stabilizes. To be sure that the valve will shut off properly, tighten this screw an additional 1/2 turn. Open and close the gun 4 or 5 times to be sure the water flow remains steady. If the flow is not steady, tighten screw "A" an additional 1/2 turn. Do not tighten beyond this point. Lock regulation screw "A" with locking nut "B".
- Adjustment of Bypass Pressure:** Close the gun. The recirculating bypass flow will be pulsating. Tighten screw "C" until the bypass flow stabilizes. Lock regulation screw "C" with locking nut "D".