

# DIMENSIONS

# SR - TR SERIES

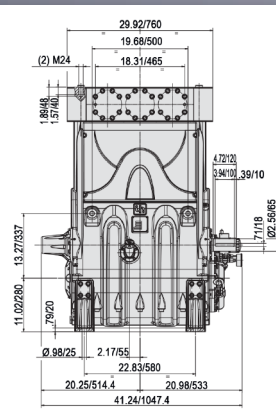
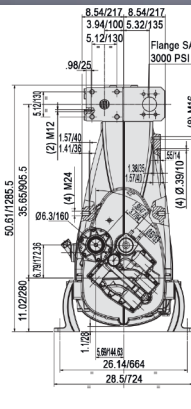
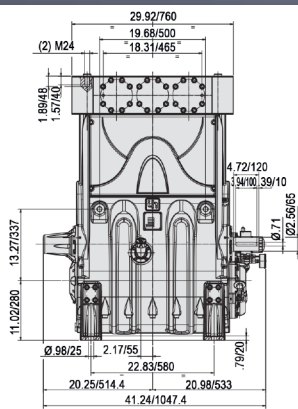
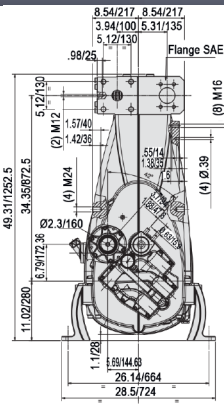

**SR50, SR55, SR60, SR65, SR70, SR75 VERTICAL**

**TR50, TR55, TR60, TR65, TR70, TR75 VERTICAL**

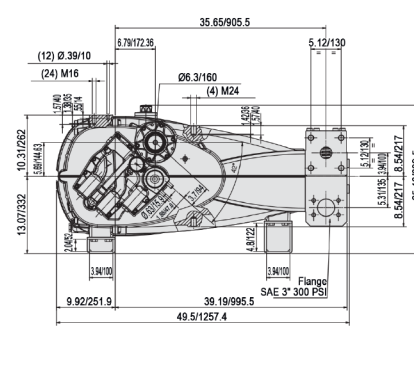
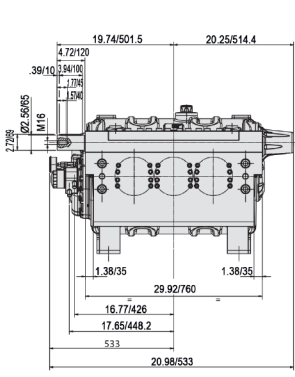
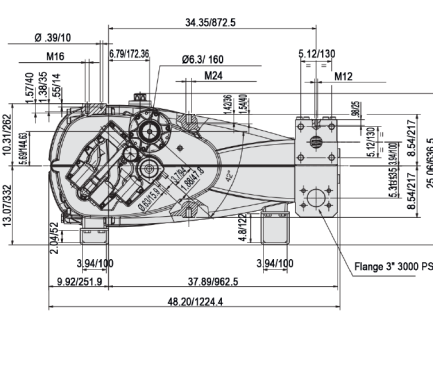
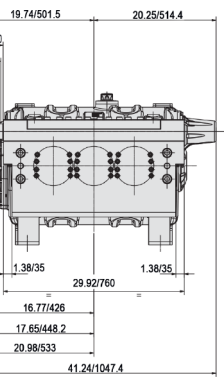

**SR50, SR55, SR60, SR65, SR70, SR75 HORIZONTAL**

**TR50, TR55, TR60, TR65, TR70, TR75 HORIZONTAL**

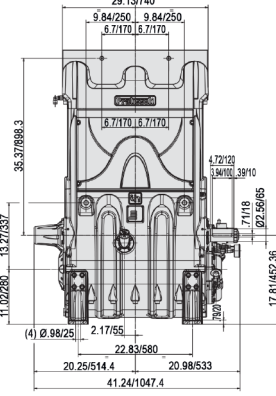
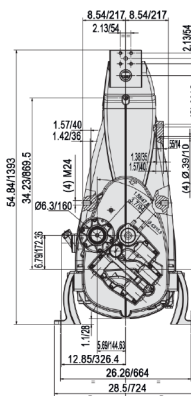
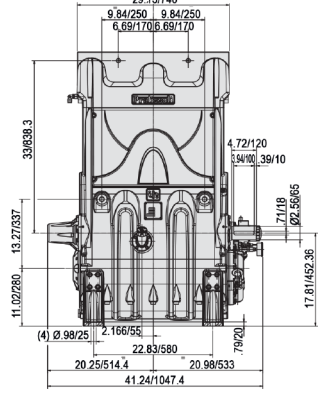
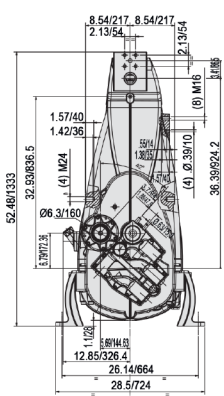

**SR26, SR30, SR32, SR36 VERTICAL**

**TR26, TR30, TR32, TR36 VERTICAL**

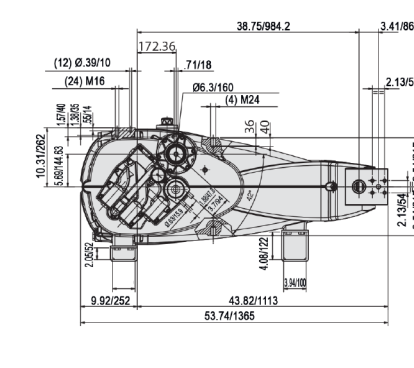
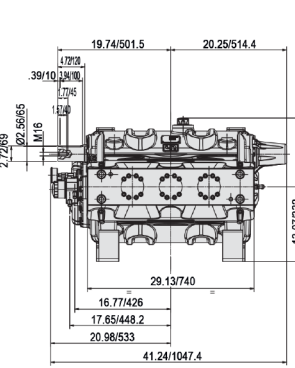
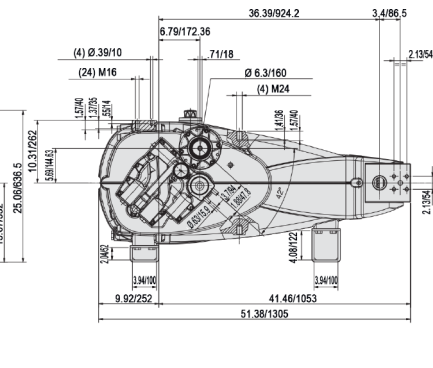
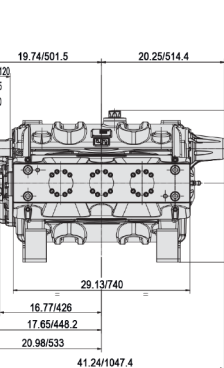

**SR26, SR30, SR32, SR36 HORIZONTAL**

**TR26, TR30, TR32, TR36 HORIZONTAL**



GENERAL PUMP  
888.474.5487 www.generalpump.com



# SR - TR SERIES

**VERTICAL OR HORIZONTAL • DOUBLE END CRANKSHAFT • INTERNAL GEAR REDUCTION • SOLID CERAMIC PLUNGERS  
FORCED OIL LUBRICATION • INTEGRATED OIL COOLER, FILTER AND GAUGE • THREE GEAR RATIOS**

1 7/4ph stainless steel manifold and abrasion resistant valves  
316 SS optional



Solid ceramic plungers

Double end crankshaft with internal gear reduction, available in three gear ratios, 1500 RPM=2.90:1, 1800 RPM=3.46:1, 2200 RPM=4.23:1

Crankcase features reinforced bed plate design and tri-metallic bronze alloy bearings

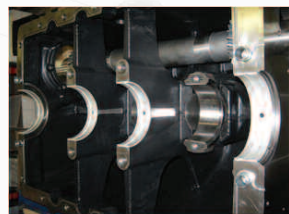

Two piece teflon-coated piston guide promotes ease of service



Buna packings are water lubricated, no greasing required

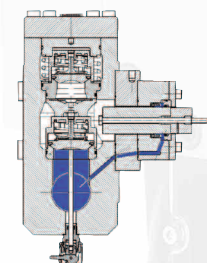

Optional teflon/graphite packings suitable for run dry and recycled fluids

Packings easily serviced without removing manifold



Bellows vs standard oil seal

Forced oil lubrication to 100% of all moving parts and integrated cooler with pressure gauge, temperature/pressure switches

## SR - TR Series - Specifications:

Inlet Pressure (High Pressure Versions)..... 75 PSI  
Inlet Pressure (High Flow Versions)..... 29-43 PSI  
Inlet Temperature (High Pressure Versions)..... 86° F  
Inlet Temperature (High Flow Versions)..... \*104° F  
Shaft Diameter.....2.56"/65 mm  
SR Stroke.....3.54"/90 mm  
TR Stroke.....5.12"/130 mm  
Maximum Internal RPM.....520  
Minimum Internal RPM.....250  
Shipping Weight..... 2,436 lbs.  
\* 140° F permissible with intermittent duty  
\*\* 200 RPM permissible with intermittent duty  
Intermittent duty: 1 hours on/4 hours off



ATEX

Group	II Area with potentially explosive atmospheres	
	2	3
Equipment Category	2	3
Zones and type of explosive atmosphere	1 (G) 21 (D)	2 (G) 22 (D)
Surface temperature of the equipment	T4 / T135 °C	

**CAN BE MOUNTED HORIZONTALLY OR VERTICALLY**



PNR4090



R4090



S4090

### INDUSTRIAL VALVES - FOR SR/TR SERIES

MODEL	GPM	MAX	INLET	OUTLET	BYPASS	SHF WGHT
<b>Pneumatic Valves:</b>						
PNR4090LP	255 GPM	3,190 PSI	Flanged Block	Flanged Block	2 1/2" BSP - F	81.5 lbs.
PNR4090	220 GPM	5,800 PSI	Flanged Block	Flanged Block	2 1/2" BSP - F	81.5 lbs.
<b>Regulating Valves:</b>						
R4090LP	255 GPM	3,190 PSI	Flanged Block	Flanged Block	2-1/2" BSP-F	81.5 lbs.
R4090	220 GPM	5,800 PSI	Flanged Block	Flanged Block	2-1/2" BSP-F	81.5 lbs.
<b>Safety Relief Valves:</b>						
S4090/200	251 GPM	2,900 PSI	1-1/2" BSP-M	Side	N/A	44.0 lbs.
S4090/300	251 GPM	4,350 PSI	1-1/2" BSP-M	Side	N/A	44.0 lbs.
S4090/400	251 GPM	5,800 PSI	1-1/2" BSP-M	Side	N/A	44.0 lbs.

## SR SERIES-300 HP-HIGH PRESSURE

MODEL	GPM	PSI
SR26	19.9 GPM	21,750 PSI
SR30	26.5 GPM	17,400 PSI
SR32	29.8 GPM	14,500 PSI
SR36	37.8 GPM	11,600 PSI

## SR SERIES-300 HP-HIGH FLOW

MODEL	GPM	PSI
SR50	73.0 GPM	5,800 PSI
SR55	88.0 GPM	5,075 PSI
SR60	105.0 GPM	4,350 PSI
SR65	123.0 GPM	3,625 PSI
SR70	143.0 GPM	3,190 PSI
SR75	164.0 GPM	2,900 PSI

Volumes shown are 100% theoretical

## TR SERIES-450 HP-HIGH PRESSURE

MODEL	GPM	PSI
TR26	28.5 GPM	21,750 PSI
TR30	37.8 GPM	17,400 PSI
TR32	43.0 GPM	14,500 PSI
TR36	54.4 GPM	11,600 PSI

## TR SERIES-450 HP-HIGH FLOW

MODEL	GPM	PSI
TR50	105.0 GPM	5,800 PSI
TR55	127.0 GPM	5,075 PSI
TR60	152.0 GPM	4,350 PSI
TR65	178.0 GPM	3,625 PSI
TR70	206.0 GPM	3,190 PSI
TR75	237.0 GPM	2,900 PSI

Volumes shown are 100% theoretical