

2100553 Flange Kit

For NEMA 56C Flanged Pumps to J609a Gas Engines



SPECIFICATIONS

Part Number:	2100553
Dimensions:	5.5" x 1"
Weight:	0.75 lbs
Materials:	Aluminum(flange) Steel (hardware)

FEATURES

- Allows NEMA 56C flanged pumps (with 3/4" hollow shaft) to attach to J609A gas engines.
- Quick and easy assembly

PARTS LIST

No.	Part No.	Description	Qty.
1	2450017	Flange, Adapter, NEMA 56C to J609A, Aluminum	1
2	2201001	Bolt, HHCS, 5/16"-24 x 3/4" Long, Steel, Black Oxide	4
3	2203512	Lock Washer, M8, Serrated Spring, Steel, Black Oxide	4
4	2203511	Lock Washer, M10, Serrated Spring, Steel, Black Oxide	4
5	2201000	Bolt, HHCS, 3/8"-16 x 1" Long, Steel, Black Oxide	4

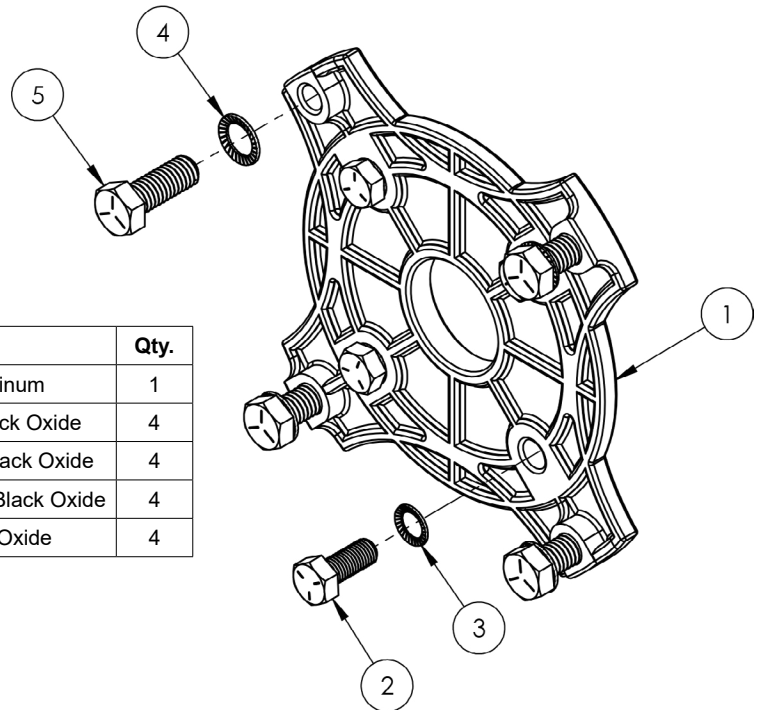

For NEMA 56C Flanged Pumps to J609a Gas Engines

DIMENSIONS

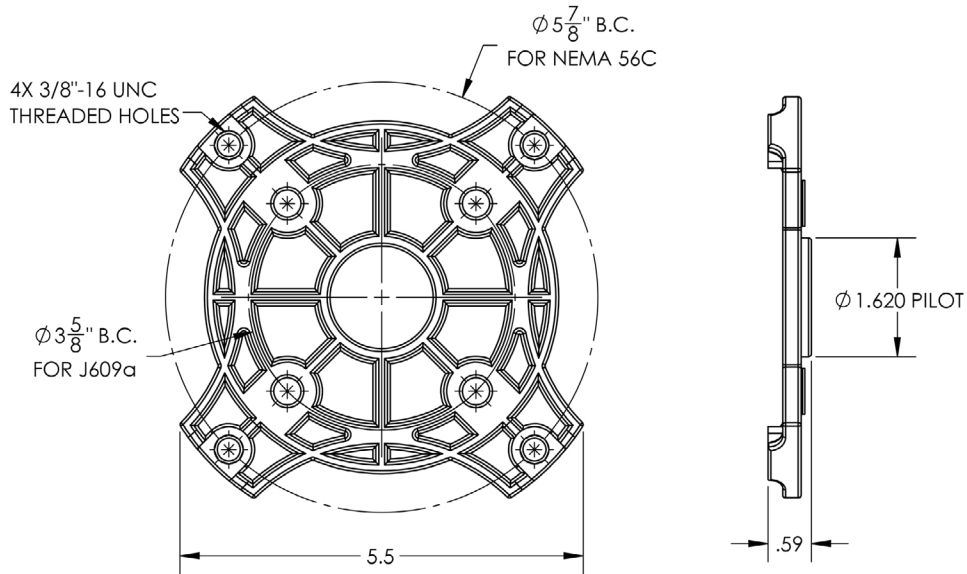

ASSEMBLY INSTRUCTIONS



STEP 1:

ATTACH FLANGE TO GAS ENGINE WITH (4) 5/16" HEX-HEAD BOLTS AND QTY (4) 5/16" SERRATED LOCK WASHERS. TORQUE TO 10-20 FT-LBS. (THREAD LOCKER OPTIONAL)

STEP 2:

APPLY A SMALL AMOUNT OF ANTI-SEIZE COMPOUND TO SHAFT OF MOTOR (OPTIONAL), THEN INSTALL PUMP USING QTY (4) 3/8" HEX-HEAD BOLTS AND QTY (4) 3/8" SERRATED LOCK WASHERS. TORQUE TO 10-20 FT-LBS (THREAD LOCKER OPTIONAL)

